

LEGEND

- EXISTING ROADWAY
- SPRING OAKS IMPROVEMENTS (HOP)
- ATWATER PHASE 1 IMPROVEMENTS (HOP)
- ATWATER LATER PHASE IMPROVEMENTS (SOUTHERN END)
- ATWATER LATER PHASE IMPROVEMENTS (NORTHERN END)
- TURNPIKE SLIP RAMP IMPROVEMENTS
- EXISTING EDGE OF ROAD
- PROPERTY LINE
- LEGAL RIGHT-OF-WAY LINE

DISTRICT	COUNTY	ROUTE	SECTION	SHEET
6-0	CHESTER	0029		1 of 1
EAST WHITELAND & CHARLESTOWN TOWNSHIPS				
REVISION NUMBER	REVISIONS	DATE	BY	

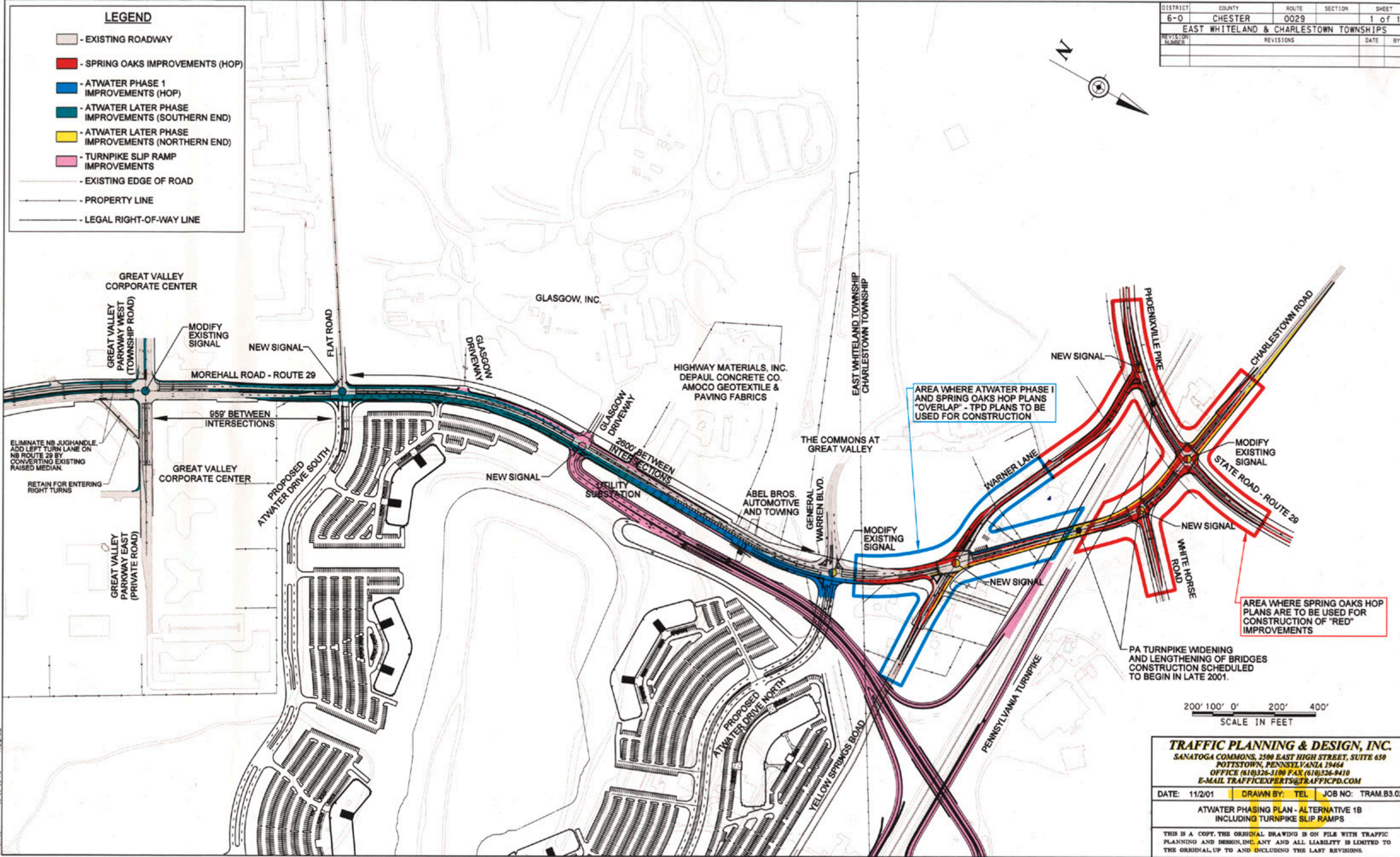
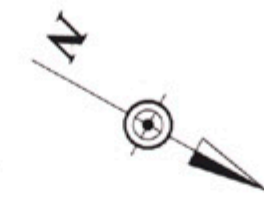

AREA WHERE ATWATER PHASE I AND SPRING OAKS HOP PLANS "OVERLAP" - TPD PLANS TO BE USED FOR CONSTRUCTION

AREA WHERE SPRING OAKS HOP PLANS ARE TO BE USED FOR CONSTRUCTION OF "RED" IMPROVEMENTS

PA TURNPIKE WIDENING AND LENGTHENING OF BRIDGES CONSTRUCTION SCHEDULED TO BEGIN IN LATE 2001.

200' 100' 0' 200' 400'
SCALE IN FEET

TRAFFIC PLANNING & DESIGN, INC.
 SANATOGA COMMONS, 2500 EAST HIGH STREET, SUITE 650
 POTTSTOWN, PENNSYLVANIA 19464
 OFFICE (610)326-3100 FAX (610)326-9410
 E-MAIL TRAFFICEXPERTS@TRAFFICPD.COM

DATE: 11/2/01 DRAWN BY: TEL JOB NO: TRAM.B3.0

ATWATER PHASING PLAN - ALTERNATIVE 1B
 INCLUDING TURNPIKE SLIP RAMPS

THIS IS A COPY. THE ORIGINAL DRAWING IS ON FILE WITH TRAFFIC PLANNING AND DESIGN, INC. ANY AND ALL LIABILITY IS LIMITED TO THE ORIGINAL, UP TO AND INCLUDING THE LAST REVISIONS.